

UNITED KINGDOM		SEASONAL RATES				VALID JAN - DEC 2010			
MODEL	BERTHS	JAN - APR		MAY - 12 JUNE 1 - 25 SEP		13 JUNE - AUG		26 SEP - DEC	
		WEEKLY	DAILY	WEEKLY	DAILY	WEEKLY	DAILY	WEEKLY	DAILY
LWB 2 Berth 250 SE LP	2	623	89	770	110	996	142	623	89
CB4 Low Profile T660 LP	4	658	94	805	115	1043	149	658	94
CB4 LWB CK	4	679	97	854	122	1064	152	679	97
CB5	5	679	97	854	122	1064	152	679	97
CB63D CB6 2+2 CB6 GAR	6	770	110	973	139	1218	174	770	110
CB7	7	861	123	1064	152	1281	183	861	123

ALL VEHICLES HAVE SHOWER & TOILET. CB7 AVAILABLE IN AUTOMATIC FOR EXTRA , 75 PER WEEK.
AVAILABLE LEIGH ON SEA, MOTHERWELL, (TRANSFERS FROM LONDON, EDINBURGH, GLASGOW, PRESTWICK FOR A FEE)

CONDITIONS
AGE LIMITS:25-70 YEARS NORMALLY (DRIVERS WITH CONVICTIONS OR ENDORSEMENTS MAY BE SUBJECT TO A PREMIUM LOADING).
ADDITIONAL DRIVER: 2nd DRIVER INCLUDED. ADDITIONAL ARE , 4.25 PER DAY PLUS VAT
DRIVING LICENCE: MUST HAVE BEEN HELD FOR MINIMUM 2 YEARS.
MINIMUM RENTAL: 1 WEEK
LONGTERM DISCOUNTS:10% FOR RENTALS OF 21 - 41 DAYS, 15% FOR 42 + DAYS.
EQUIPMENT: INCLUDED IN RATES
TRANSFERS: FROM LONDON OR HEATHROW TO DEPOT FOR A FEE OF , 85 PLUS VAT, FROM GATWICK OR STANSTED , 75+VAT, FROM GLASGOW, EDINBURGH OR PRESTWICK , 65+VAT.
L.L.I: INCLUDED WITH NON WAIVEABLE EXCESS OF , 500 (DAMAGE TO TYRES, WINDOWS, INTERNAL FITTINGS NOT INCLUDED)
DAMAGE ABOVE CAB HEIGHT IS REGARDED AS NEGLIGENCE AND CHARGES UPTO , 2000 WILL APPLY.
REFUNDABLE DEPOSIT: , 500
TAX: VAT 17.5% INCLUDED
CONTINENTAL INSURANCE: , 140 PLUS VAT FOR FIRST 2 WEEKS, THEREAFTER , 40 PLUS VAT PER WEEK. FOR IRELAND , 120 PLUS VAT PER HIRE.
ONE WAY RENTALS: SUBJECT TO AVAILABILITY. FEES WILL VARY DEPENDING ON LOCATION.(, 300 BETWEEN LEIGH ON SEA AND MOTHERWELL)
RESERVATION DEPOSIT:ON CONFIRMATION, , 200
CANCELLATION CHARGES: 8-6 WEEKS PRIOR , 200, 6-4 WEEKS PRIOR 20%, 4- 2 WEEKS PRIOR 30%, 2-0 WEEKS 100%



LWB 2 BERTH

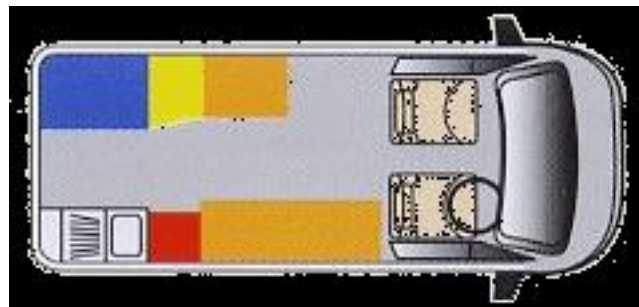

250 SE LP

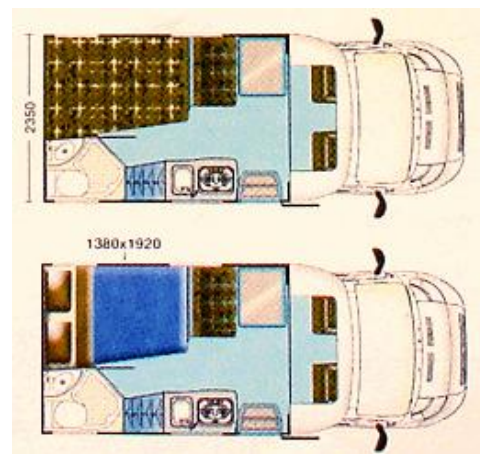

T660 LOW PROFILE

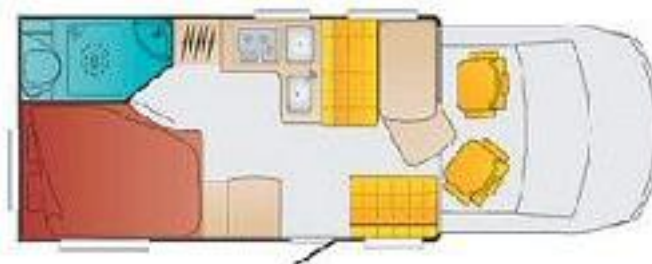

Camargue 1

CB4 LOW PROFILE

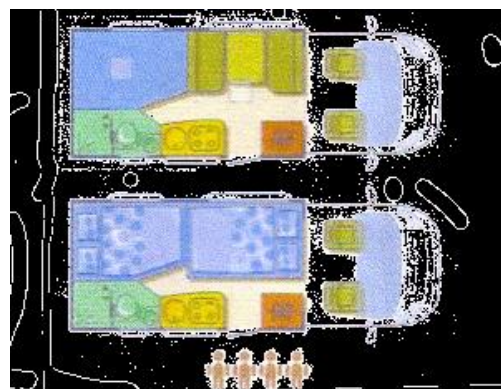

CB4 LWB CK

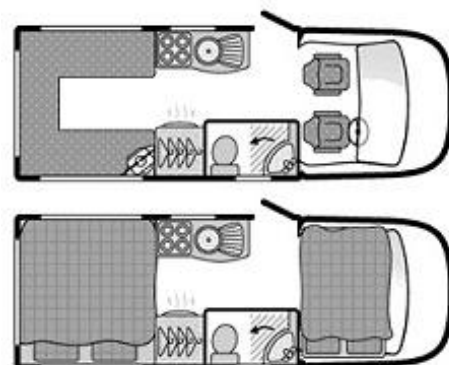



CB 5

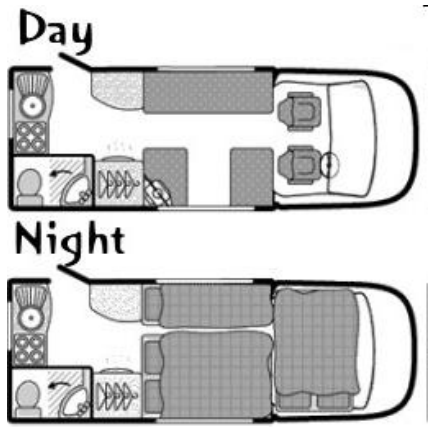

CB 63D

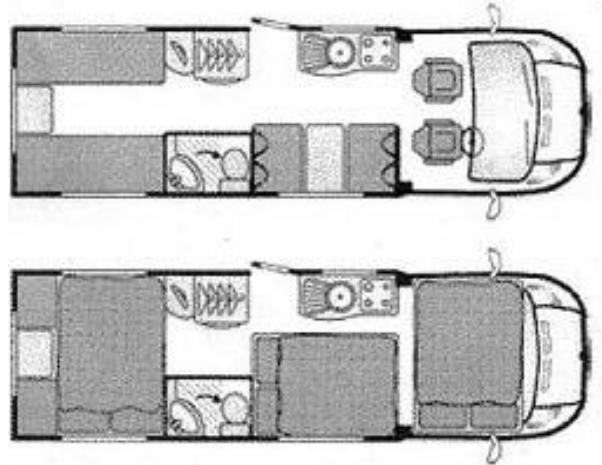

CB6 2+2

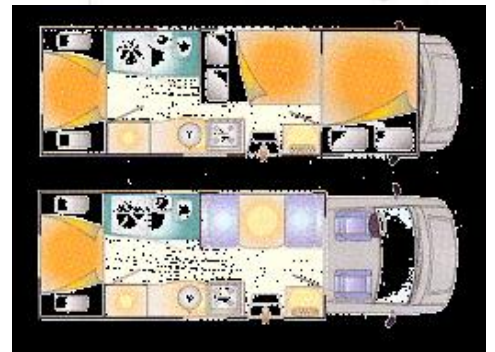

CB6 GAR

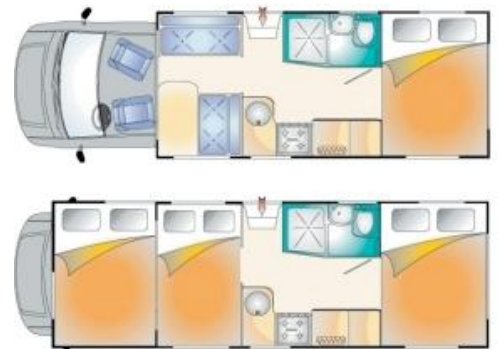

CB 7

